

CAST STAINLESS STEEL

GATE VALVES BOLTED BONNET

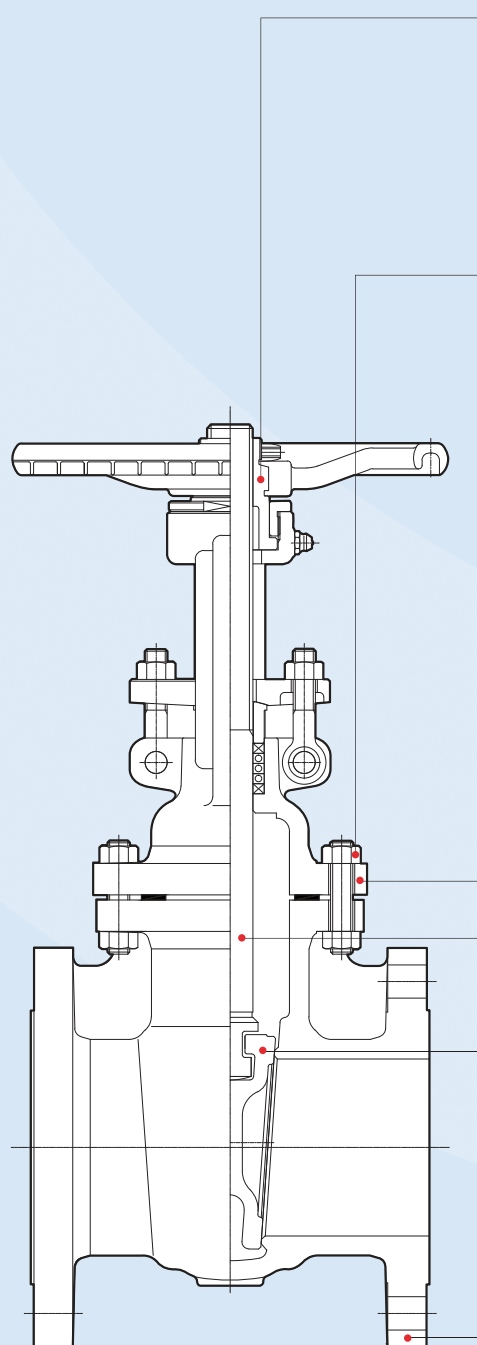

YOKE SLEEVE

The upper portion of the Yoke Sleeve is hexagonally tapered to fix hand-wheel. The standard material of the Yoke Sleeve is Nodular Ni-resist D2 with over 1150°C(2100°F) dissolution point in accordance with API std. specifications.

BOLTING

Bonnet studs and nuts are manufactured from alloy or stainless steel to the relevant ASTM standard.

BONNET

The bonnet is in stainless steel. It is machined to accept the yoke sleeve and incorporates a stuffing box dimension in accordance with the API standard.

STEM

The stem is part of the trim, A stem is provided with a T-head. A ground backseat is provided to endure perfectly tight seal to the stuffing box when the valve is fully open.

The stem is ground to minimize friction and prevent damage to gland packing. The threading is trapezoidal TW type dimensions comply with the applicable standard.

WEDGE

The wedge is part of the trim. It is normally supplied as flexible. It is connected to the stem by means of a T-joint. The guides on each side of the wedge are casted for proper alignment with the body guides. Special attention is given to the seating surface, which are ground and lapped to insure a perfectly tight seal.

BODY

The body is in cast stainless steel and is carefully designed in all its details.

The basic dimension, i.e. wall thickness, face to face and flanges comply with the relevant API and ANSI standard. The sealing surface for connection to the bonnet are flat finish in the 150lb Class, recessed in the 300lb Class or may be ring joint in the 150lb Class in the 600lb Class and above. Bosses may be provided for drain taps or by-pass piping.

CAST STEEL

INDUSTRIAL VALVES
CAST STAINLESS STEEL

NO	NAME OF PART	ASTM SPECIFICATION				
		STANDARD	CORROSION SERVICE			
1	BODY	A351-CF8/+STL	A351-CF8M/+STL	A351-CF3/+STL	A351-CF3M/+STL	A351-CN7M/+STL
2	BONNET	A351-CF8	A351-CF8M	A351-CF3	A351-CF3M	A351-CN7M
3	WEDGE	A351-CF8/+STL	A351-CF8M/+STL	A351-CF3/+STL	A351-CF3M/+STL	A351-CN7M/+STL
4	YOKE	A351-CF8				
5	STEM	A479-304	A479-316	A479-304L	A479-316L	ALLOY 20
6	YOKE SLEEVE	A439-D2C				
8	GLAND FLANGE	A351-CF8/A240-304				
9	PACKING GLAND	A479-304	A479-316	A479-304L	A479-316L	ALLOY 20
20	BONNET BOLT	A193-B8				
21	BONNET NUT	A194-B				
22	YOKE BOLT	A193-B8				
23	YOKE NUT	A194-B				
24	HINGE BOLT	A193-B8				
25	HINGE NUT	A194-B				
26	HINGE PIN	A479-304				

* Note 1, Packing & gasket material : customer's requirements.

NO	NAME OF PART	ASTM SPECIFICATION
11	SLEEVE NUT	A479-304
12	WHEEL NUT	A351-CF8
14	HAND WHEEL	A536-60
29	SET SCREW	304
32	GREASE NIPPLE	304
34	PACKING	GRAPHITE
36	SPIRAL WOUND GASKET	GRAPHITE+304

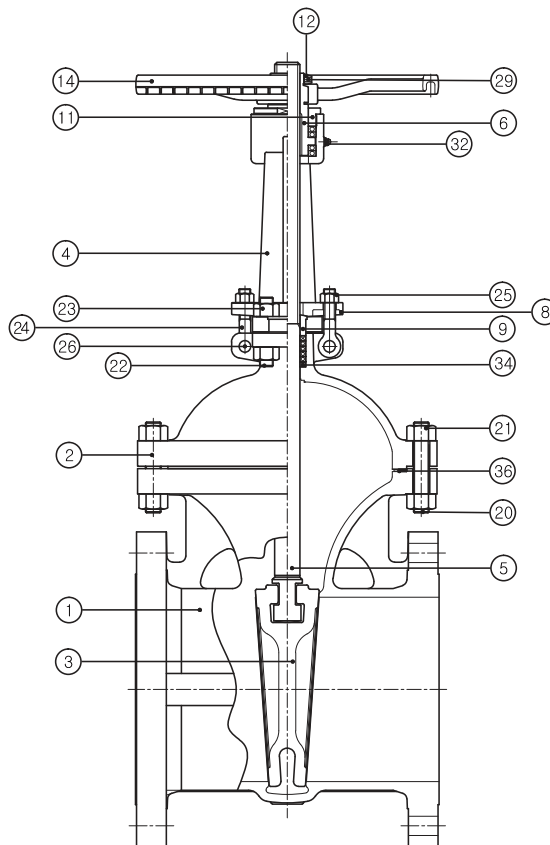
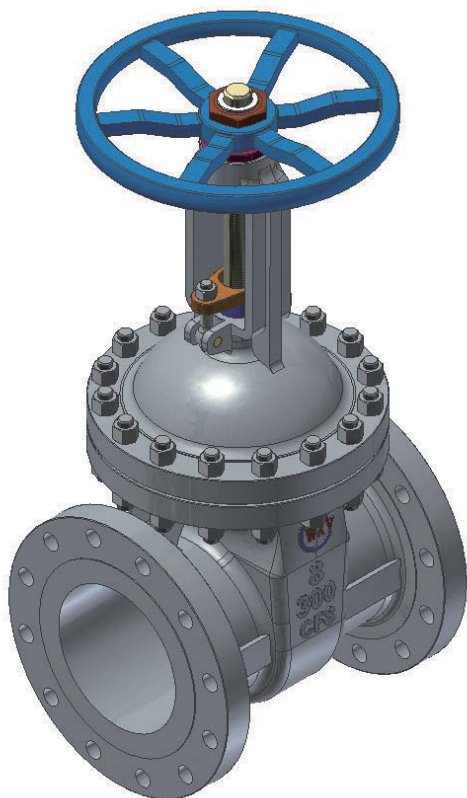

CAST STEEL

INDUSTRIAL VALVES
ASME CLASS 150

VALVE SIZE	inch	2	2½	3	4	5	6	8	10	12	14	16	18	20	24
	mm	50	65	80	100	125	150	200	250	300	350	400	450	500	600
L1	inch	7,0	7,5	8,0	9,0	10,0	10,5	11,5	13,0	14,0	15,0	16,0	17,0	18,0	20,0
	mm	178	191	203	229	254	267	292	330	356	381	406	432	457	508
L3	inch		9,5	11,12	12,0	15,0	15,88	46,5	18,0	19,75	22,5	24,0	26,0	28,0	32,0
	mm		241	283	305	381	403	419	457	502	572	610	660	711	813
H	inch	14,0	15,2	16,8	20,9	25,2	28,5	37,2	43,9	52,0	55,9	59,0	78,7	86,6	102,3
	mm	356	386	426	531	641	724	945	1116	1321	1420	1500	2000	2200	2600
W	inch	7,1	7,1	7,9	8,8	9,8	9,8	12,4	14,0	15,7	17,7	19,7	19,7	24,8	24,8
	mm	180	180	200	224	250	250	315	355	400	450	500	500	630	630
WEIGHT	LB	44,1	55,1	66,2	97,0	132,3	154,4	233,7	368,2	526,9	760,7	1080,5	1274,5	1611,9	2280,0
	kg	20	25	30	44	60	70	106	167	239	345	490	578	731	1043

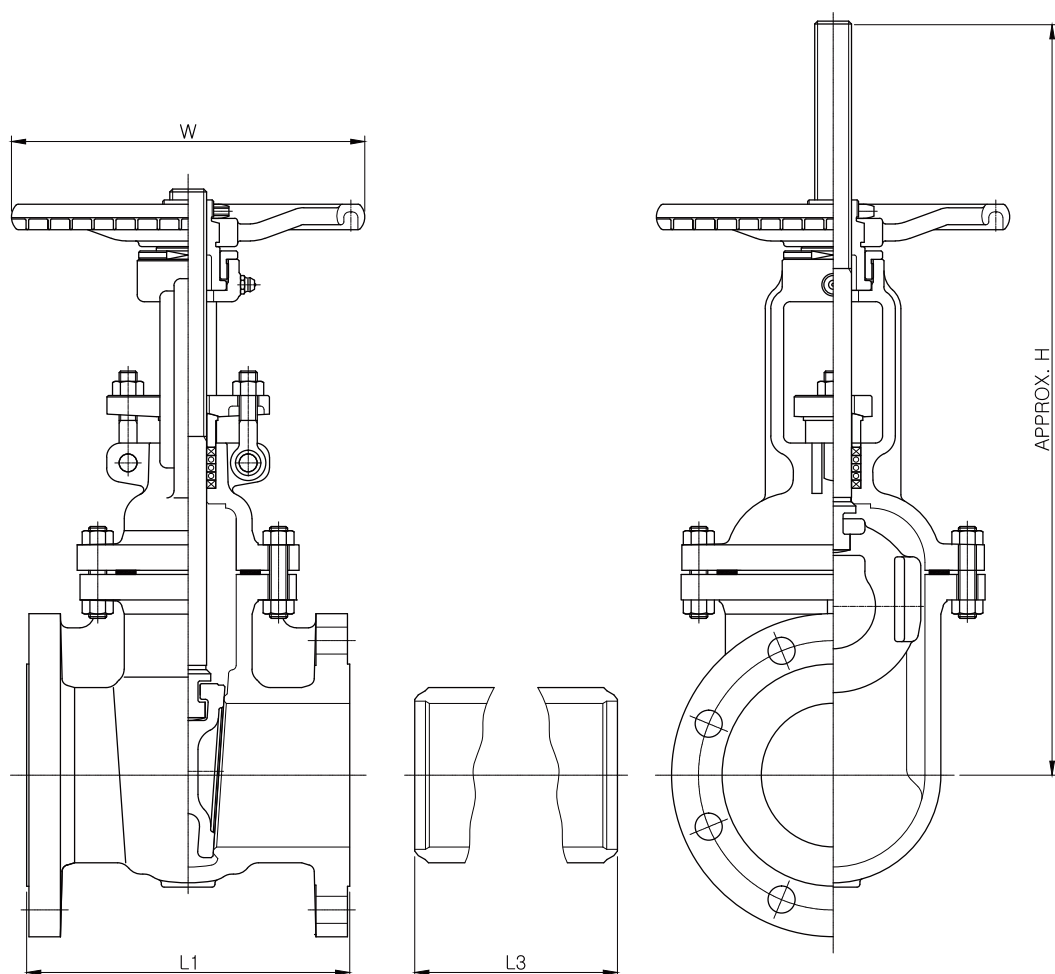

CAST STEEL

INDUSTRIAL VALVES
ASME CLASS 300

VALVE SIZE	inch	2	2 ½	3	4	5	6	8	10	12	14	16	18	20	24
	mm	50	65	80	100	125	150	200	250	300	350	400	450	500	600
L1 & L3	inch	8,5	9,5	11,12	12,0	15,0	15,88	16,5	18,0	19,75	30,0	33,0	36,0	39,0	45,0
	mm	216	241	283	305	381	403	419	457	502	762	838	914	991	1143
H	inch	14,5	15,7	17,4	21,5	26,2	30,0	38,5	45,8	59,1	63,0	72,8	86,6	101,6	106,3
	mm	370	400	442	546	667	761	979	1163	1500	1600	1850	2200	2580	2700
W	inch	7,9	7,9	8,8	9,8	12,4	14,0	15,7	17,7	19,7	19,7	19,7	24,8	24,8	27,9
	mm	200	200	224	250	315	355	400	450	400	500	500	630	630	710
WEIGHT	LB	52,9	75,0	90,4	143,3	209,5	257,9	401,3	268,2	1060,6	1528,1	2094,8	2535,8	3307,5	4961,3
	kg	24	34	41	65	95	117	182	355	481	693	950	1150	1500	2250

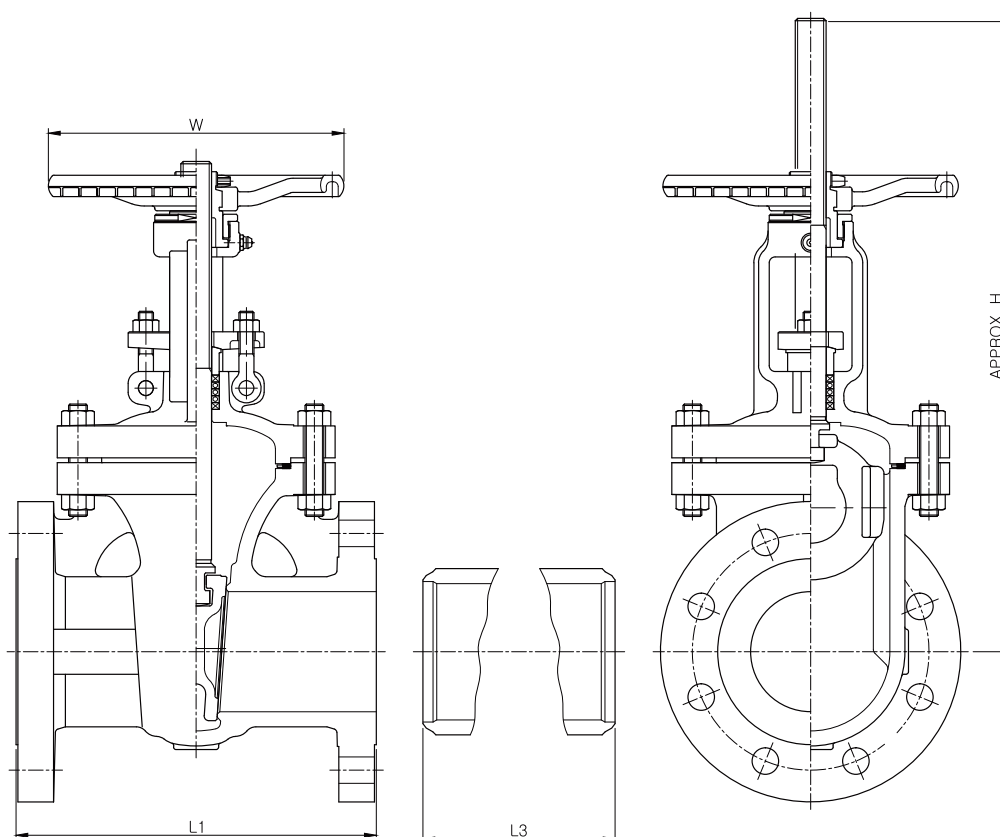

CAST STEEL

INDUSTRIAL VALVES
ASME CLASS 600

VALVE SIZE	inch	2	2 ½	3	4	5	6	8	10	12	14	16	18	20	24
	mm	50	65	80	100	125	150	200	250	300	350	400	450	500	600
L1 & L3	inch	11,5	13,0	14,0	17,0	20,0	22,0	26,0	31,0	33,0	35,0	39,0	43,0	47,0	55,00
	mm	292	330	356	432	508	556	660	787	838	889	991	1092	1194	1397
H	inch	18,7	21,6	23,5	26,8	31,5	36,6	45,7	53,1	61,8	72,1	82,9	98,0	104,8	116,9
	mm	475	550	598	680	800	930	1160	1350	1570	1832	2106	2489	2662	2970
W	inch	7,7	7,7	9,4	11,8	14,0	17,7	17,7	19,7	22,0	22,0	27,9	27,9	31,5	35,4
	mm	195	195	240	300	355	450	450	500	560	560	710	710	800	900
WEIGHT	LB	79,4	127,9	154,4	269,0	441	551,2	893,0	1433,2	1896,3	2734,2	3109,1	4890,7	6198,3	8656,8
	kg	36	58	70	122	200	250	405	650	860	1240	1410	2218	2811	3926

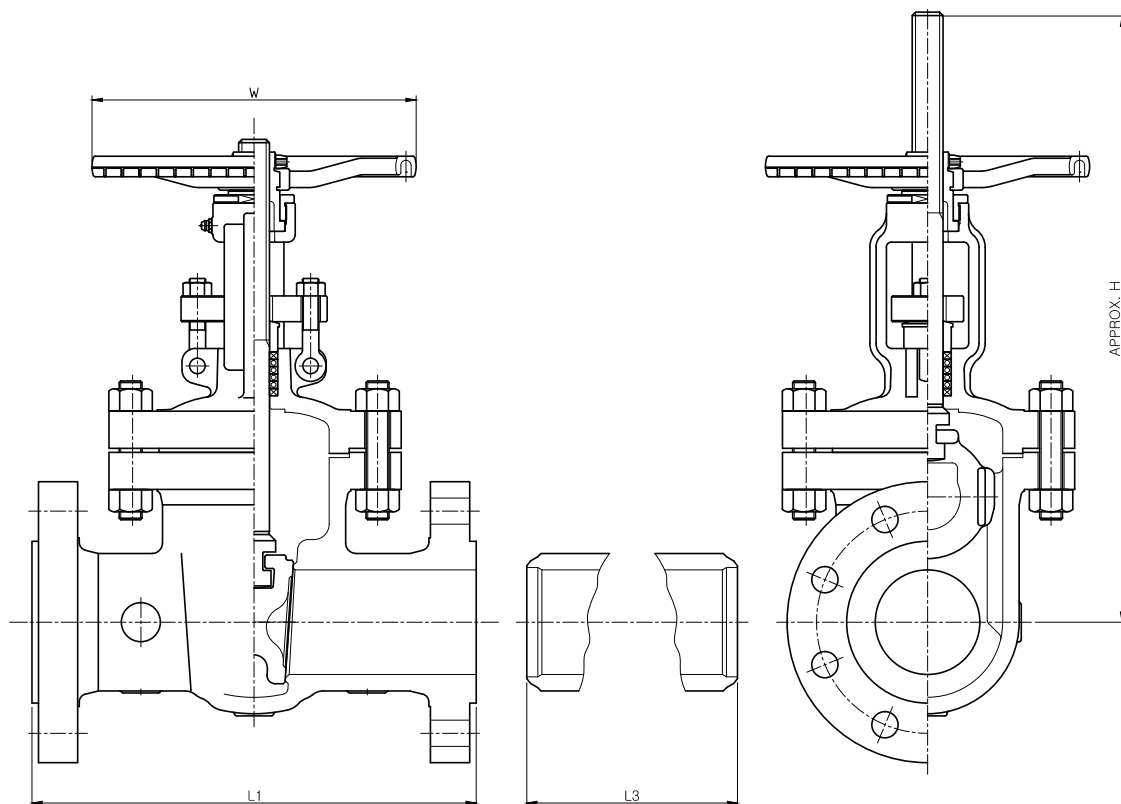

CAST STEEL

INDUSTRIAL VALVES
ASME CLASS 900

VALVE SIZE	inch	2	2½	3	4	5	6	8	10	12	14	16	18	20	24
	mm	50	65	80	100	125	150	200	250	300	350	400	450	500	600
L1 & L3	inch	14,5	16,5	15,0	18,0	22,0	24,0	29,0	33,0	38,0	40,5	44,5	48,0	52,0	61,0
	mm	368	419	381	457	559	610	737	838	965	1029	1130	1219	1321	1549
H	inch	21,2	26,4	26,4	30,8	37,1	42,4	55,5	67,7	77,4	74,9	80,7	88,8	110,2	124,0
	mm	539	670	672	782	943	1076	1411	1720	1965	1902	2051	2256	2800	3150
W	inch	11,8	11,8	14,0	15,7	19,7	22,0	17,7	22,0	22,0	24,0	24,0	30,0	30,0	24,0
	mm	300	300	355	400	500	560	450	560	560	610	610	760	760	610
WEIGHT	LB	181	341,8	364	384	661,5	999	1720	2752	3400	4895,1	6615	8533,4	10716,3	16096,5
	kg	82	155	165	174	300	453	780	1248	1542	2220	3000	3870	4860	7300

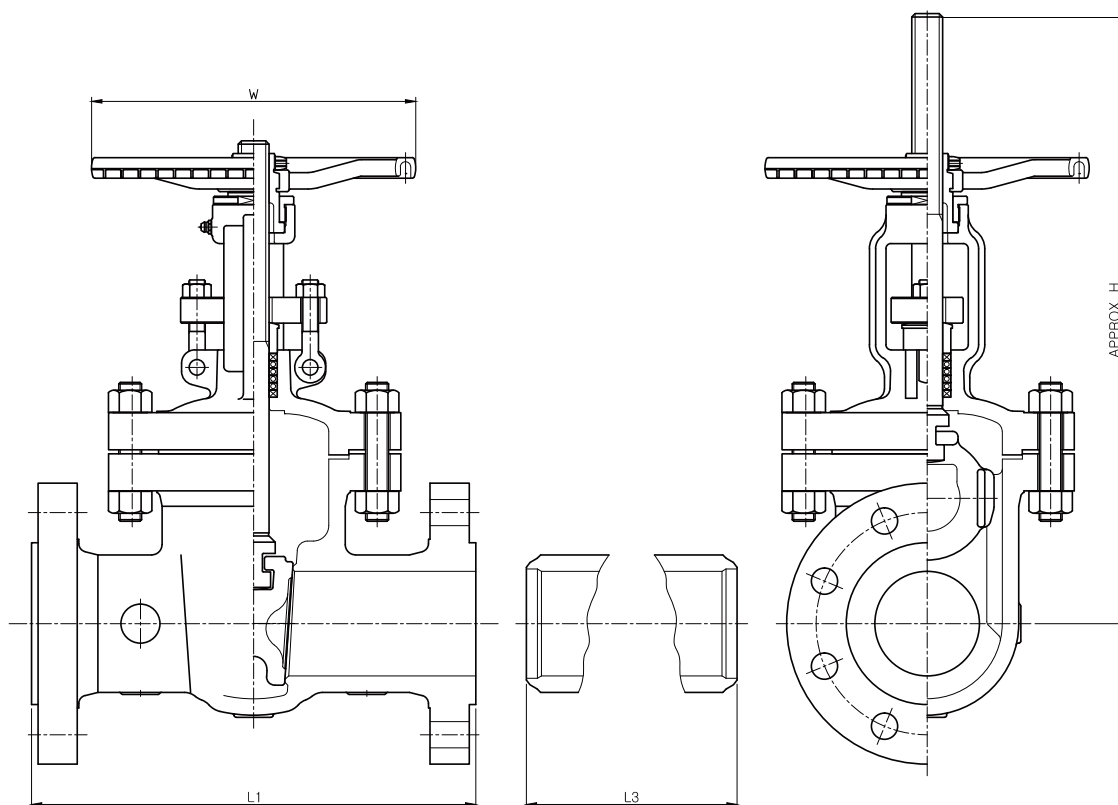

CAST STEEL

INDUSTRIAL VALVES
ASME CLASS 1500

VALVE SIZE	inch	2	2½	3	4	5	6	8	10	12	14	16
	mm	50	65	80	100	125	150	200	250	300	350	400
L1 & L3	inch	14,5	16,5	18,5	21,5	26,5	27,75	32,75	39,0	44,5	49,5	54,5
	mm	368	419	470	546	673	705	832	991	1130	1257	1384
H	inch	21,2	26,4	29,1	30,8	43,62	47,0	60,8	66,5	82,3	85,1	97,9
	mm	539	670	738	783	1108	1196	1546	1688	2090	2167	2486
W	inch	11,8	11,8	15,7	19,7	24,8	13,8	22,0	27,9	27,9	30,0	30,0
	mm	300	300	400	500	630	350	560	710	710	760	760
WEIGHT	LB	181	341,8	401	573	926,1	1360	3175	4412	8417	9073,6	15324,8
	kg	82	155	182	260	420	617	1440	2001	3816	4115	6950

